

# 2021-2025 FORD MUSTANG MACH-E FRONT INTERIOR LIGHTBAR

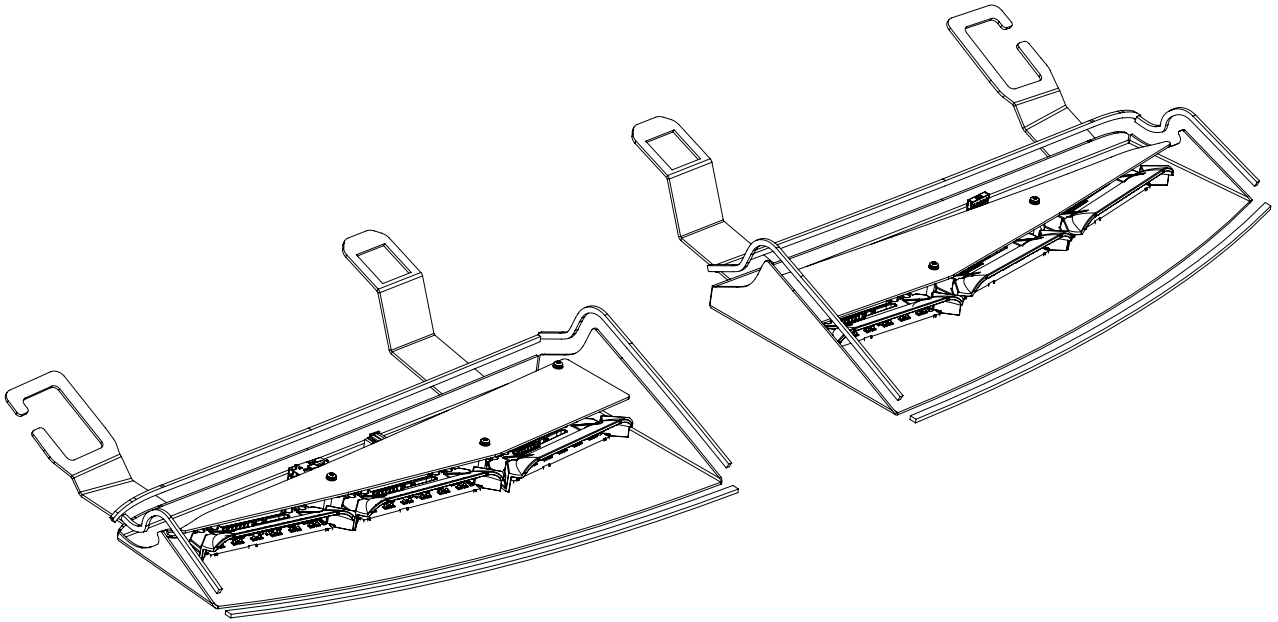

## ⚠ WARNING ⚠

- HIGH CURRENT interconnects must be properly terminated. Poor crimp quality can cause heat build-up and fire. Follow crimp connector manufacturer instructions.
- DO NOT install this product or route any wires in the Air Bag Deployment Zone. Refer to vehicle Owner's Manual for deployment zones.
- Do NOT use system to disconnect headlights, brake lights or other safety equipment.
- Failure to properly install connectors, fuses or wiring may cause vehicle failure or fire.
- Installation must only be performed by trained technician. Installer must determine vehicle wiring configuration and proper integration of system.
- Use proper wire gauge. All power wires connecting to positive (+) or negative (-) battery terminal or local chassis ground (-) must be sized to supply at least 125% of max. current and properly fused at power source.
- Install protective grommets when routing wire through firewall or metal.
- Unit may become hot to touch during normal operation.

INTRODUCTION. . . . .	2
COMPONENTS . . . . .	2
INSTALLATION INSTRUCTIONS . . . . .	2
INSTALLATION IMAGES . . . . .	3

## ⚠ WARNING

ROUTE WIRES ONLY IN LOCATIONS THAT ARE NOT SUBJECTED TO POTENTIAL WEAR. MAKE SURE TO AVOID ROUTING WIRES IN THE DEPLOYMENT AREA OF YOUR AIR BAG. REFER TO YOUR VEHICLE'S OWNER'S MANUAL FOR AIRBAG DEPLOYMENT ZONES.



nForce Interior Lightbar  
Product Page

### NOTICE:

Installers and users must comply with all applicable federal, state and local laws regarding use and installation of warning devices. *Improper use or installation may void warranty coverage.* To review our Limited Warranty Statement & Return Policy for this or any SoundOff Signal product, visit our website at [soundoffsignal.com/tech-services/returns/](https://soundoffsignal.com/tech-services/returns/). If you have questions regarding this product, contact **Technical Services**, Monday - Friday, 8 a.m. to 5 p.m. ET at 800-338-7337 (press #4). Questions or comments that do not require immediate attention may be emailed to [techservices@soundoffsignal.com](mailto:techservices@soundoffsignal.com).

ENHANCING SAFETY THROUGH INNOVATION

**SoundOff  
Signal** 

800-338-7337 | [soundoffsignal.com](https://soundoffsignal.com)

nForce Interior Lightbar 2021-2025 Ford Mach-E FRONT  
BDKPJL 0525 REV C

Thank you for purchasing the Ford Mach-E nForce Rear interior light bar. This kit is compatible with the 2021 – 2025 Ford Mach-E select, GT and Premium trim levels.

- 3 module, split design
- Top cover incorporated into this front interior lightbar design, for improved look and installation
- Improved wire management incorporated into design
- Powder coat is smoother, less textured, than traditional SoundOff Signal interior lightbars

CONTAINS		
ITEM #	COMPONENT	QTY.
1	3-MOD INTERIOR LIGHT BAR - DRIVER	1
2	3-MOD INTERIOR LIGHT BAR - PASSENGER	1
3	INNER MOUNT BRACKET	2
4	DRIVER OUTER MOUNT BRACKET	1
5	PASSENGER OUTER MOUNT BRACKET	1
6	1/4-20 X 3/8" PHILLIPS PAN HEAD SCREW	4
7	1/4" STAR LOCK WASHER	4
8	THIN TRIM	7.5'
9	PRODUCT WARNING CARD	1
10	INSTALLATION/INSTRUCTION SHEET(S)	1
11	CA PROP 65 LABEL	1

1. We recommend using the thin gaskets provided and apply to the specified edges called out on **FIG. 1**.
2. Using a trim tool to remove the cover piece on the outer pivot visor mount. Once the cover is off, move it out of the way, then remove the torx screw holding the pivot mount in place.
3. Take the outer bracket with the wire pass through slot in it and position in the correct position seen in **FIG 3**. Then re-install the pivot visor mount but leave a little loose for adjustability in the later steps.
4. To install the inside bracket, remove the screw from the inside of the visor clip. This will allow the visor clip to be removed. Once visor clip is removed put the inside bracket in the correct place seen in **FIG. 3** and then re-install the inside visor clip.
5. Take the correct shroud and mount it to the installed brackets. You may need to tilt and adjust the shroud into position. Once shroud is in the correct location use the ¼-20 screws and lock washers to tighten down the shroud to the brackets as seen in **FIG. 4**.
6. Once the shroud is tightened down to the brackets, tighten both visor clip screws for optimal fitment.
7. Repeat Steps 1-7 for the other side's shroud installation.

FIG. 1

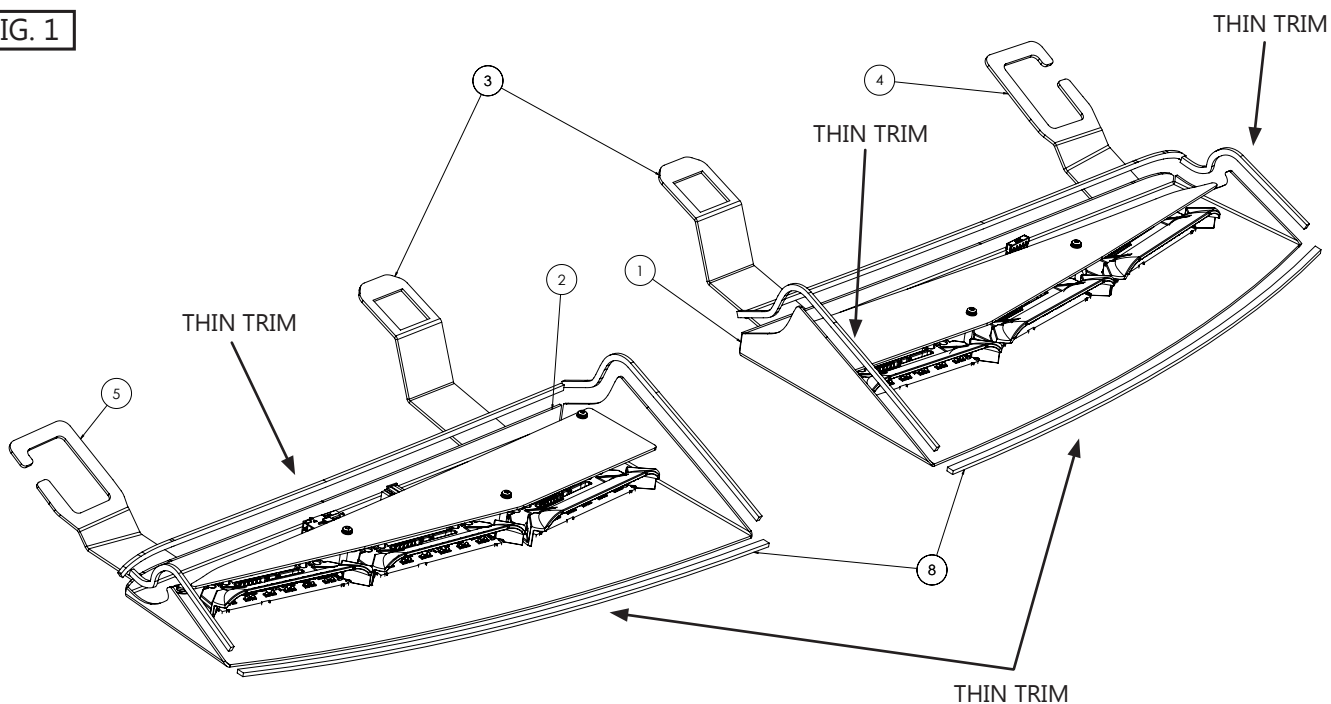

FIG. 2

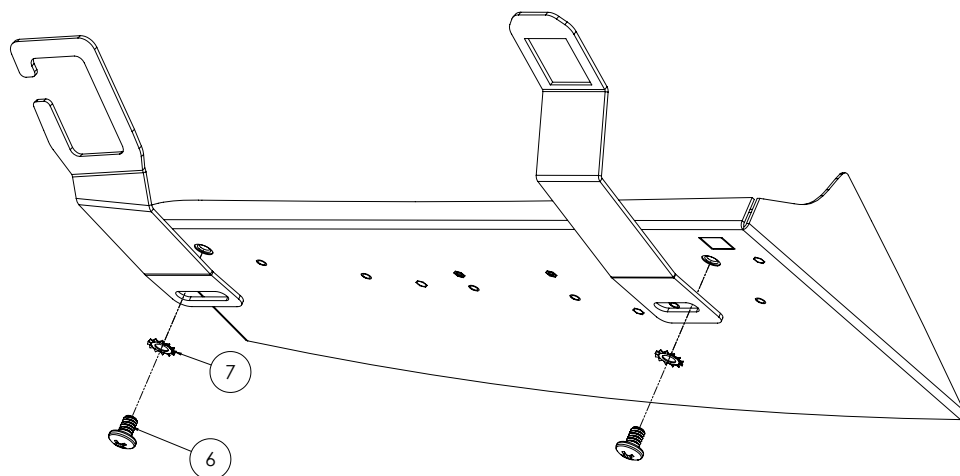

FIG. 3

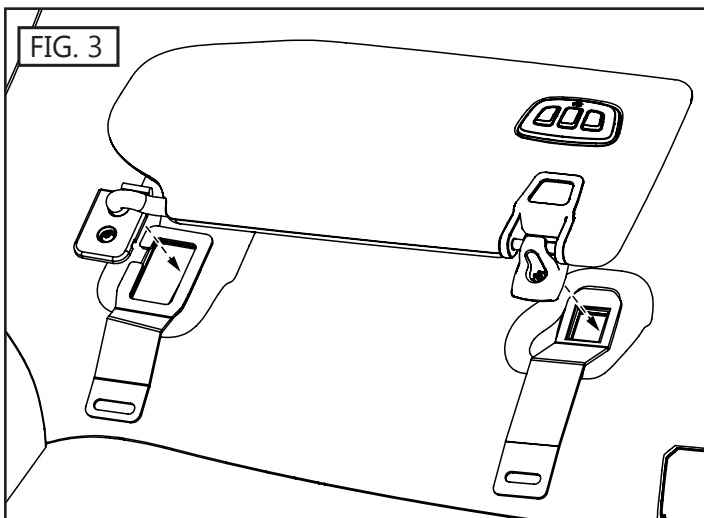

FIG. 4

