

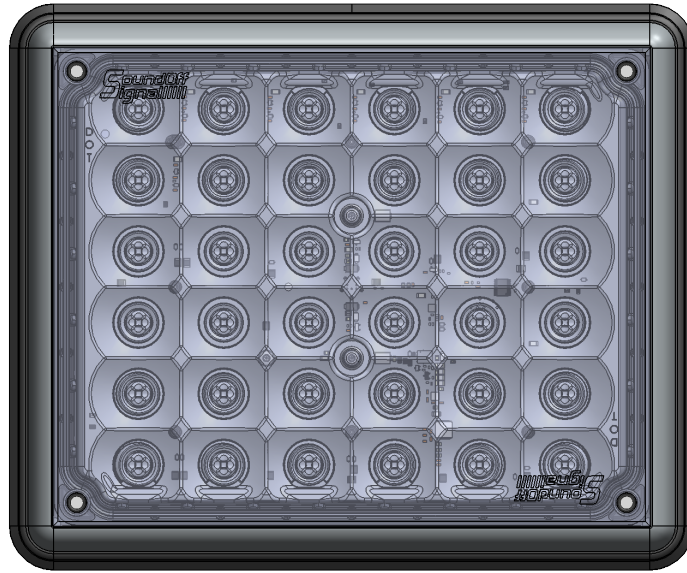

9x7 STOP/TAIL & TURN LIGHTS

EMPSE15C(X)-(X) - 9X7 Screw & Stud Mount



Protected by U.S. Patents Pending
<https://soundoffsignal.com/legal/patent-notification/>

WARNING

- HIGH CURRENT interconnects must be properly terminated. Poor crimp quality can cause heat build-up and fire. Follow the crimp connector manufacturer instructions.
- DO NOT install this product or route any wires in the Air Bag Deployment Zone. Refer to vehicle Owner's Manual for deployment zones.
- Do NOT use system to disconnect headlights, brake lights or other safety equipment.
- Unit may become hot to touch during normal operation.
- Failure to properly install connectors, fuses or wiring may cause vehicle failure or fire.
- Installation must only be performed by trained technician. Installer must determine vehicle wiring configuration and proper integration of system.
- Use proper wire gauge. All power wires connecting to positive (+) or negative (-) battery terminal or local chassis ground (-) must be sized to supply at least 125% of max. current and properly fused at power source.
- Install protective grommets when routing wire through firewall or metal.
- Petroleum/silicone based lubricants will cause the silicone lens to discolor.

DIMENSIONS 2

WARNING LIGHT OPTIONS 2

TECHNICAL SPECIFICATIONS 3

WIRING INFORMATION 4

STUD MOUNT INSTALLATION 5

SCREW MOUNT INSTALLATION . . 6-7

RETENTION CLIP INSTRUCTIONS . . . 8

REPLACEMENT PARTS 9

WARNING

ROUTE WIRES ONLY IN LOCATIONS THAT ARE NOT SUBJECTED TO POTENTIAL WEAR. MAKE SURE TO AVOID ROUTING WIRES IN THE DEPLOYMENT AREA OF YOUR AIR BAG. REFER TO YOUR VEHICLE'S OWNER'S MANUAL FOR AIRBAG DEPLOYMENT ZONES.



1.800.338.7337 / www.soundoffsignal.com

NOTICE:

Installers and users must comply with all applicable federal, state and local laws regarding use and installation of warning devices. *Improper use or installation may void warranty coverage. To review our Limited Warranty Statement & Return Policy for this or any SoundOff Signal product, visit our website at www.soundoffsignal.com/tech-services/returns/. If you have questions regarding this product, contact **Technical Services**, Monday - Friday, 8 a.m. to 5 p.m. ET at 1.800.338.7337 (press #4). Questions or comments that do not require immediate attention may be emailed to techservices@soundoffsignal.com.*

ENHANCING SAFETY THROUGH INNOVATION

9X7 Silicone_STT
0000KP 0923 REV A

TECHNICAL SPECIFICATIONS:

MPOWER® 9X7 STOP/TAIL LIGHT TECHNICAL SPECIFICATIONS		
	Input Voltage:	9-32Vdc
	STOP/TAIL LIGHT CURRENT CONSUMPTION (Amps)	
	12.8Vdc	25.6Vdc
	Peak	Peak
STOP	0.26	0.13
TAIL	0.05	0.03

MPOWER® 9X7 TURN LIGHT TECHNICAL SPECIFICATIONS				
	STOP/TAIL LIGHT CURRENT CONSUMPTION (Amps)			
	12.8Vdc		25.6Vdc	
	Peak	Average	Peak	Average
TURN	0.30	0.15	0.17	0.09
AFTER POWER IS ON, touching the WHITE wire to the ground will allow you to change various settings on the module. (Refer to page 4)				

SCREW MOUNT (SOUNDOFF STANDARD) INSTALLATION: //

1. Remove the four, white packaging extrusions from the perimeter of the light.
2. Drill for SoundOff Signal mount pattern. Reference **Fig. 8** for hole sizes.
3. Place the bezel behind the light.
4. Place Bezel and light onto gasket.
5. Insert supplied screws through the bezel, light, and gasket.
6. Place flat washers onto inserted screws.
7. Attach the well nuts to the screws. Hold the screws in place and hand tighten the well nuts against the flat washers to secure. Ensure the lip of the bezel is properly seated in the gasket.
8. Pull the wire harness through the opening and plug into the back of the light (see wiring diagram). Reference **page 8** for retention clip installation.
9. Secure the entire light assembly to the mounting surface. Insert the well nuts into the drilled holes and tighten to 7 turns past full contact.
10. Insert (4) Silicone Plugs into the light to seal screw holes. (Use a 50% Isopropyl alcohol, 50% deionized water mix for lubrication if necessary).

NOTE: Tighten until gasket is compressed. **DO NOT** over tighten. **DO NOT USE POWER DRIVER.** Horizontal and vertical orientations indicated on gasket for proper drainage.

⚠ WARNING
 PETROLEUM/SILICONE BASED
 LUBRICANTS WILL CAUSE THE
 SILICONE LENS TO DISCOLOR.

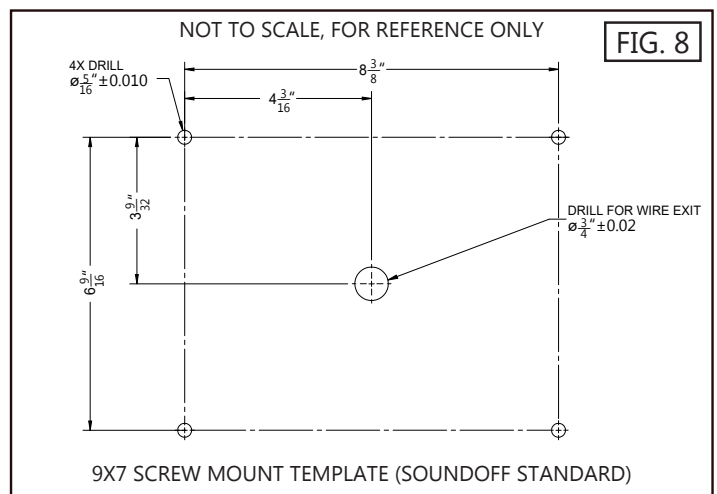
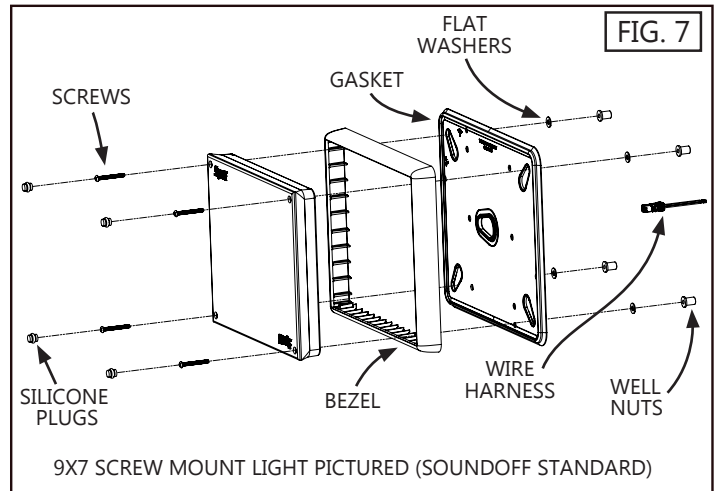

SCREW MOUNT (LEGACY STANDARD) INSTALLATION: //

1. Remove the four, white packaging extrusions from the perimeter of the light.
2. Drill for Legacy Standard hole pattern. Reference **Fig. 10** for hole sizes.
3. Insert well nuts into drilled holes, fully seat to mount surface.
4. Align gasket to mount surface (note horizontal and vertical orientations indicated on gasket for proper seal).
5. Place (4) adapter castings into gasket openings.
6. Insert (4) screws through (4) adapter castings into (4) washers and (4) well nuts and tighten to secure to vehicle surface. Tighten to 7 turns past full contact (Press screw into well nut to improve bite and prevent spinning. Hand tighten until well nut is secure).
7. Pull the wire harness through the opening and plug into the back of the light (see wiring diagram). Reference **page 8** for retention clip installation.
8. Place the bezel behind the light.
9. Place the light and bezel into gasket, pressing light, bezel, and gasket against mount surface.
10. Secure the assembly using (4) supplied screws. Tighten to 1/8 turn past full contact.
11. Insert (4) Silicone Plugs into the light to seal screw holes. (Use a 50% Isopropyl alcohol, 50% deionized water mix for lubrication if necessary).

NOTE: Tighten until gasket is compressed. **DO NOT** over tighten. **DO NOT USE POWER DRIVER.** Horizontal and vertical orientations indicated on gasket for proper drainage.

WARNING
 PETROLEUM/SILICONE BASED
 LUBRICANTS WILL CAUSE THE
 SILICONE LENS TO DISCOLOR.

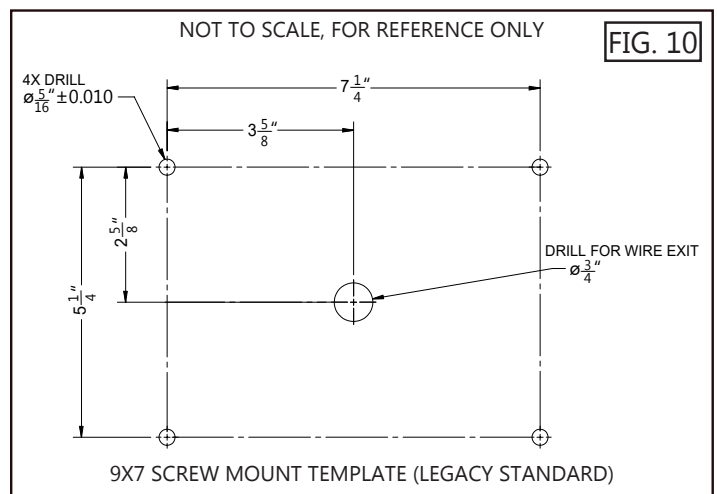
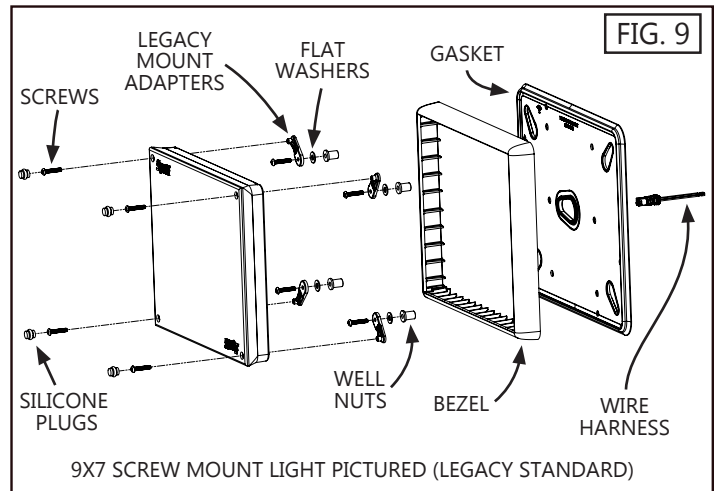

9X7 SILICONE REPLACEMENT PARTS & ACCESSORIES: //

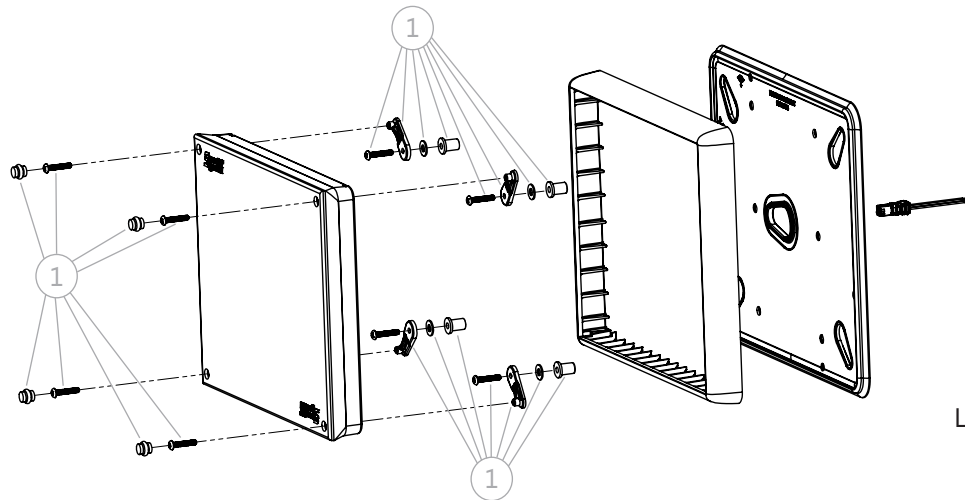

LEGACY STANDARD
SCREW MOUNT

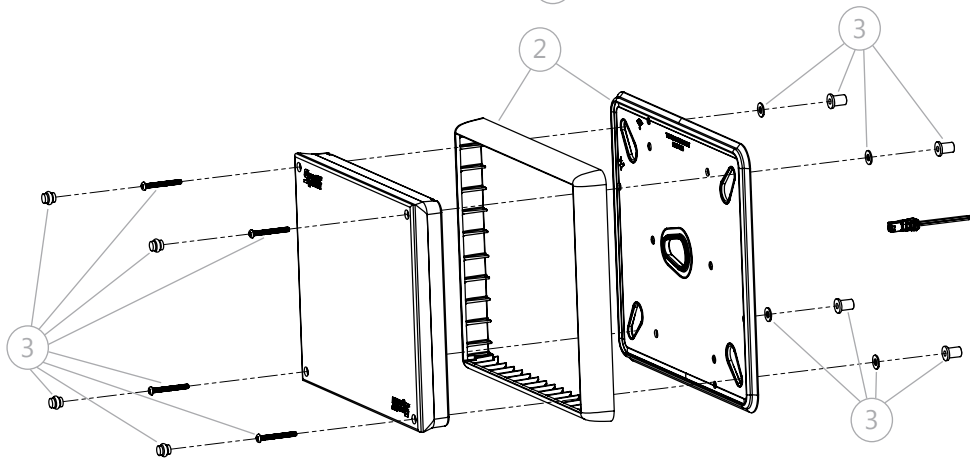

SOUNDOFF STANDARD
SCREW MOUNT

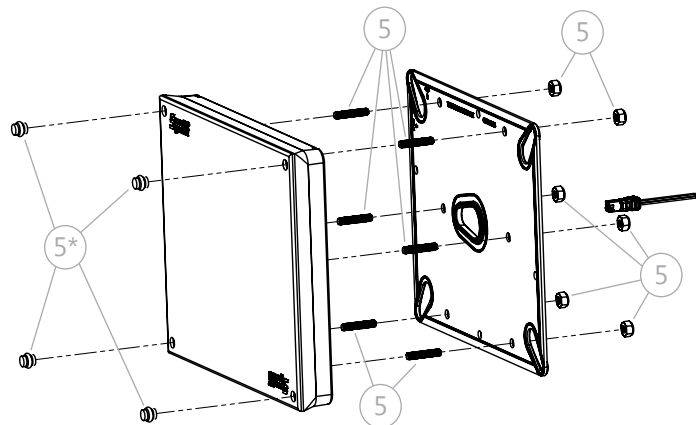

STUD MOUNT

ITEM #	PART#	DESCRIPTION
1	PMP9HK01-SM	LEGACY MOUNT ADAPTER KIT
2	PMP9BZL01B	MPOWER 9X7 SINGLE BLACK
2	PMP9BZL01C	MPOWER 9X7 SINGLE CHROME
3	PMP9HK02-SM	SCREW MOUNT KIT (FOR SUBSTRATE UP TO 0.157" THICK)
4	PMP9HK03-SM	SCREW MOUNT KIT (FOR SUBSTRATE 0.157" TO 0.354" THICK) (NOT SHOWN)
5	PMP9HK05-ST	STUD MOUNT KIT
6	PMP9HK04	MPOWER 9X7 CORNER PLUG KIT*

*mPower Corner Plug Kit (PMP9HK04) is included in Item #1, #3, #4, & #5 along with being sold separately as Item #6.

WARRANTY & RETURN GOODS PROCEDURE

CLEANING & CARE OF YOUR LIGHT:

Keeping the lenses clean and scratch free will optimize the performance of the light. The exterior of the light including lenses should be cleaned with mild soapy water and a soft cotton cloth to remove dirt, grime and insects. Never use window cleaners or harsh chemicals on the lenses; this may cause failure of the lenses or reduce clarity resulting in the reduction of light output.

MOUNTING INTEGRITY:

A review of bolt/hardware/mounting bracket integrity should be performed at the beginning and end of each shift.

WARNING MESSAGES - PLEASE READ:

WARNING - CARE MUST BE TAKEN WHEN DRILLING THROUGH THE VEHICLE NOT TO DRILL INTO ANY EXISTING WIRING AND NOT TO DRILL THROUGH THE HEADLINER OR SUPPORT MEMBERS OF THE VEHICLE. CHECK BOTH SIDES OF THE MOUNTING SERVICE PRIOR TO DRILLING. DE-BURR ANY HOLES AND REMOVE ANY METAL SHARDS OR REMNANTS.

WARNING - ROUTE WIRES ONLY IN LOCATIONS THAT ARE NOT SUBJECTED TO POTENTIAL WEAR. MAKE SURE TO AVOID ROUTING WIRES IN THE DEPLOYMENT AREA OF YOUR AIR BAG. REFER TO YOUR VEHICLE OWNER'S MANUAL FOR AIR BAG DEPLOYMENT ZONES.

WARNING - ALL CUSTOMER SUPPLIED POWER WIRES CONNECTING TO THE POSITIVE (+) OR NEGATIVE (-) BATTERY TERMINAL OR LOCAL CHASSIS GROUND (-) MUST BE SIZED TO SUPPLY AT LEAST 125% OF THE MAXIMUM CURRENT AND PROPERLY FUSED AT THE POWER SOURCE WITH APPROPRIATELY RATED FUSE.

IMPORTANT: When passing cables through fire wall or other sheet metal, insert grommet to protect the cable!

WARRANTY RETURN PROCESS:

Please scan QR code or visit
<https://soundoffsignal.com/support-page/returns/>



Alternatively contact your SoundOff Signal Sales Representative, Customer Services staff or our Technical Department (800.338.7337) for a RMA #, Return Merchandise Authorization Number.

The following information is required for issuance of the RMA #:

- Reason for returning the product*
- Address where replacement product is to be shipped*
- Telephone number where you may be reached*
- SoundOff Signal invoice number on which product was purchased**
- SoundOff Signal part number and serial number**
- E-mail address where RMA # should be e-mailed**
- Fax number where RMA # should be faxed**

* RMA # will not be given without this information.

** If available, please provide this information.

SoundOff Signal will NOT accept returns without an RMA #. Each RMA # is good for only one (1) return and will expire (30) days after the date it was issued. Products must be shipped back to SoundOff Signal and the RMA # clearly marked on the outside of the package near the shipping label. Please use the following address on your shipping label:

SoundOff Signal
ATTN: RMA # / Technical Services
3900 Central Parkway
Hudsonville, MI 49426

WARRANTY EXCLUSIONS:

Shipping & Handling, labor and service fees are non-refundable. SoundOff Signal is not liable for any damage due to installation or personal injury as a result of using SoundOff Signal product.

WARRANTY FORFEITURE:

Warranty will not be granted if the Warranty Return Policy & Procedure rules are not strictly followed. Physical damage resulting from customer abuse will void warranty. Warranty will also be voided if any SoundOff Signal and/or manufacturer serial tags, product stickers, seals, or the like, are removed, altered or tampered with. Returned product that is damaged by shipping via the RMA # procedure is not the responsibility of SoundOff Signal.

Document effective date on cover and below supersedes previously dated policies and statements.

There are no other warranties, expressed or implied, including, but not limited to, any implied merchantability or fitness for a particular use. SoundOff Signal reserves the right to modify this warranty statement at any time; or to discontinue, modify, or upgrade any products of its manufacture with design improvements without prior notice.