

PNT3BKUMB2-(x) - 2014-2022 Dodge Ram Classic Under Mirror Mount Bracket Kit for Intersector Surface Mount & mpower® 3" and 4" Stud Mount

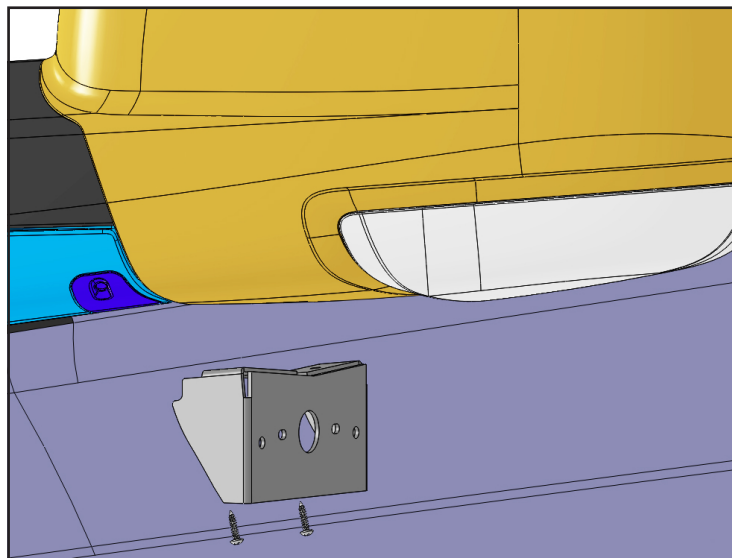

INSTALLATION:

1. Ensure side mirror is still attached to vehicle.
2. Put screws into bracket, threads facing up.
3. Put paint in the top of each screw.
4. Align bracket on vehicle at light's desired location.
5. Take care to transfer paint from end of screw to mirror surface to mark drill location.
6. Take mirror off of the vehicle.
7. Use #25 drill bit to drill clearance hole for a 6-32 machine screw.
8. Mount bracket to mirror using provided 6-32 screws.
9. Mount light to bracket.
10. Use 3/8" drill bit to drill hole in mirror for the wire harness to go through.
11. Mount mirror back onto vehicle.

⚠ WARNING

- HIGH CURRENT interconnects must be properly terminated. Poor crimp quality can cause heat build-up and fire. Follow crimp connector manufacturer instructions.
- DO NOT install this product or route any wires in the Air Bag Deployment Zone. Refer to vehicle Owner's Manual for deployment zones.
- Do NOT use system to disconnect headlights, brake lights or other safety equipment.
- Unit may become hot to touch during normal operation.
- Failure to properly install connectors, fuses or wiring may cause vehicle failure or fire.
- Installation must only be performed by trained technician. Installer must determine vehicle wiring configuration and proper integration of system.
- Use proper wire gauge. All power wires connecting to positive (+) or negative (-) battery terminal or local chassis ground (-) must be sized to supply at least 125% of max. current and properly fused at power source.
- Install protective grommets when routing wire through firewall or metal.

NOTICE:

Installers and users must comply with all applicable federal, state and local laws regarding use and installation of warning devices.

Improper use or installation may void warranty coverage.

To review our Limited Warranty Statement & Return Policy for this or any SoundOff Signal product, visit our website at www.soundoffsignal.com/tech-services/returns/.
If you have questions regarding this product, contact **Technical Services**, Monday - Friday, 8 a.m. to 5 p.m. or after hours 5 p.m. to 8 p.m. ET at 1.800.338.7337 (press #4).
Questions or comments that do not require immediate attention may be emailed to techservices@soundoffsignal.com.

**SoundOff
Signal** 

1.800.338.7337 / www.soundoffsignal.com

SUPERIOR CUSTOMER RELATIONSHIPS. SMARTLY DESIGNED LIGHTING & ELECTRONIC SOLUTIONS.