

## obSERVE Dome Light, 6"

UNIVERSAL MODEL: ECVDMILTAL00

CHARGER MODEL: ECVDMILTALDC

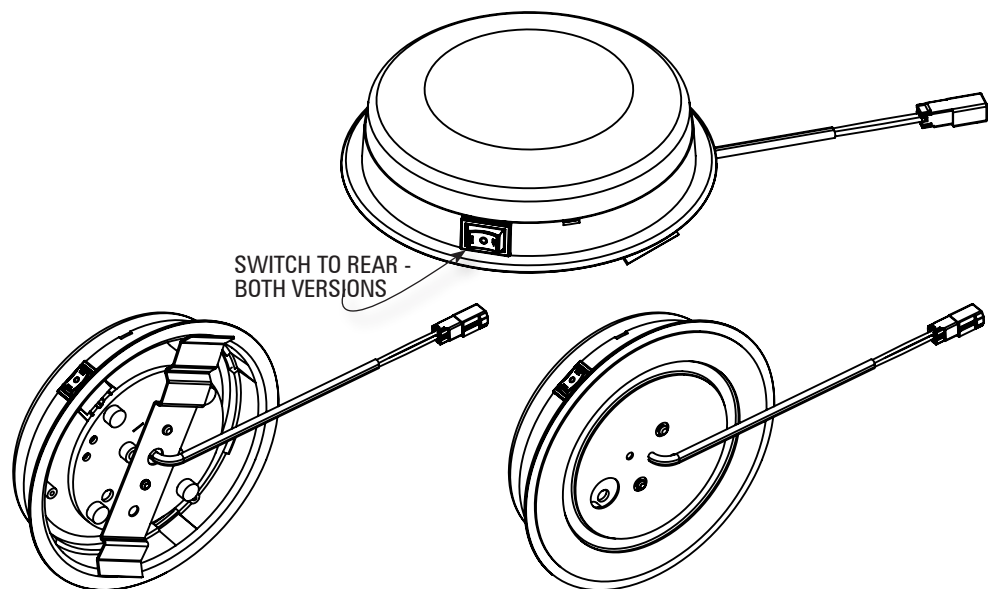

CHARGER MODEL:  
ECVDMILTALDC

UNIVERSAL MODEL: ECVDMILTAL00

### ⚠ WARNING

- HIGH CURRENT interconnects must be properly terminated. Poor crimp quality can cause heat build-up and fire. Follow crimp connector manufacturer instructions.
- DO NOT install this product or route any wires in the Air Bag Deployment Zone. Refer to vehicle Owner's Manual for deployment zones.
- Do NOT use system to disconnect headlights, brake lights or other safety equipment.
- Unit may become hot to touch during normal operation.
- Failure to properly install connectors, fuses or wiring may cause vehicle failure or fire.
- Installation must only be performed by trained technician. Installer must determine vehicle wiring configuration and proper integration of system.
- Use proper wire gauge. All power wires connecting to positive (+) or negative (-) battery terminal or local chassis ground (-) must be sized to supply at least 125% of max. current and properly fused at power source.
- Install protective grommets when routing wire through firewall or metal.

### INSTALLATION:

1. Remove the lens from the Dome Light.
2. Using the two (2) holes in the Dome Light Reflector as a template, mark the location of the holes to be drilled.
3. Make electrical connections. Black wire is ground (-) and white wire is + 10-30Vdc.
3. Mount the Dome Light using two (2) #6 screws (not supplied).
4. Replace the Dome Light lens.

### NOTE

1. Be careful NOT to drill a hole in the vehicle's roof when mounting the Dome Light in the headliner. Make sure you are drilling into a roof support member and use short screws.
2. Be careful when installing screws to not damage or touch electrical components near the mounting holes with either screws or the tool being used to install screws.

### OPERATION:

Switch positions shown below:

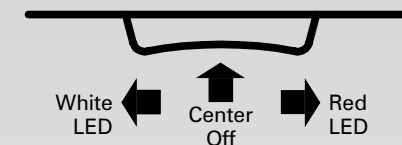

### TECHNICAL SPECIFICATIONS

Overall Dimensions:	n6.2" x 1.5"D
Input Voltage Range:	10 - 30 Vdc
Current Consumption:	<0.2 amps
# of LEDs:	White: 12 Red: 12
Operating Temperature:	-40° to +65° C
'B' Black Wire:	Ground (-)
'A' White Wire:	Power (10-30Vdc)

### ⚠ WARNING

This product contains high intensity LED devices. To prevent eye damage, DO NOT stare into the light beam at close range.

### NOTICE:

Installers and users must comply with all applicable federal, state and local laws regarding use and installation of warning devices.

Improper use or installation may void warranty coverage. To review our Limited Warranty Statement & Return Policy for this or any SoundOff Signal product, visit our website at [www.soundoffsignal.com/sales-support](http://www.soundoffsignal.com/sales-support). If you have questions regarding this product, contact **Technical Services**, Monday - Friday, 8 a.m. to 5 p.m. or after hours 5 p.m. to 8 p.m. EST at 1.800.338.7337 (press #4 to skip the automated message). Questions or comments that do not require immediate attention may be emailed to [techservices@soundoffsignal.com](mailto:techservices@soundoffsignal.com).

SUPERIOR CUSTOMER RELATIONSHIPS. SMARTLY DESIGNED LIGHTING & ELECTRONIC SOLUTIONS.

**SoundOff**  
**Signal**  
Smart Design.

1.800.338.7337 / [www.soundoffsignal.com](http://www.soundoffsignal.com)

ECVDMILTALIMP-ECVDMILTAL00 0623